

Gregory Ain Mar Vista Tract (2003)

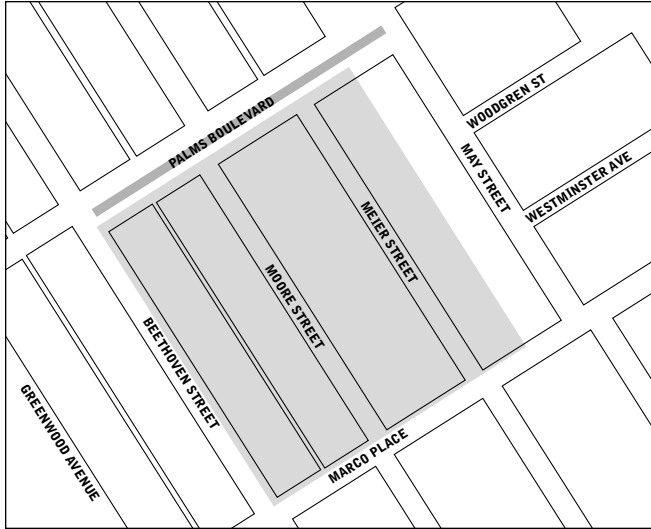

THE GREGORY AIN MAR VISTA TRACT IS THE CITY'S FIRST HPOZ composed solely of postwar-era homes. Designed in the late 1940s by noted architect Gregory Ain, in collaboration with Joseph Johnson and Alfred Day, the tract is notable for its application of the best of mid-century Modern design to affordable homes.

Each of the original 52 homes in the tract was roughly 1,050 square feet. To keep costs low, a single house type was used with variety achieved by the placement of the garage and by turning some of the houses at a right angle to the street. Lush landscaping by the famed landscape architect Garrett Eckbo was also incorporated into the tract plan.

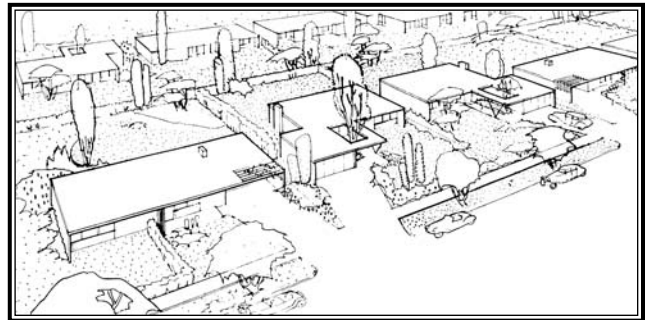
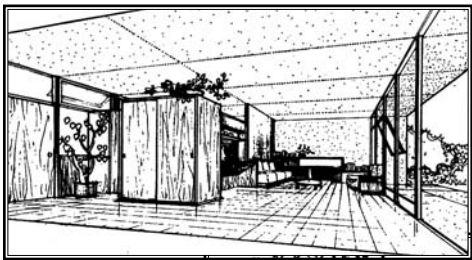

Photo by Julius Shulman. © J. Paul Getty Trust, The Getty Research Institute



Photo: Larry Underhill

