



Development of a Comprehensive Modernization Project at **Abraham Lincoln Senior High School**

林肯高中
全面現代化項目的發展進度



Community Meeting
April 10, 2019

社區會議
2019年4月10日

Overview – Comprehensive Modernization Project

概述 - 全面現代化項目

Lincoln High School was identified for the development of a “Comprehensive Modernization Project” - December 2016

Project Scope

- The project will address the most critical physical conditions of school buildings and grounds
 - Focus on safety
 - Limit work on less critical items
- Project Budget: \$218.3 Million
- Anticipated Schedule Completion: Q4-2026

林肯高中於2016年12月確定成為校園發展地點而發展一個「全面現代化項目」

項目範圍

- 此項目將應對學校建築及校園現有最緊要問題
 - 安全
 - 局限比較不重要的事項
- 項目預算：2.183億元
- 預計完成時間表: 2026年的第四季度

Anticipated Project Timeline 預計之項目時間表

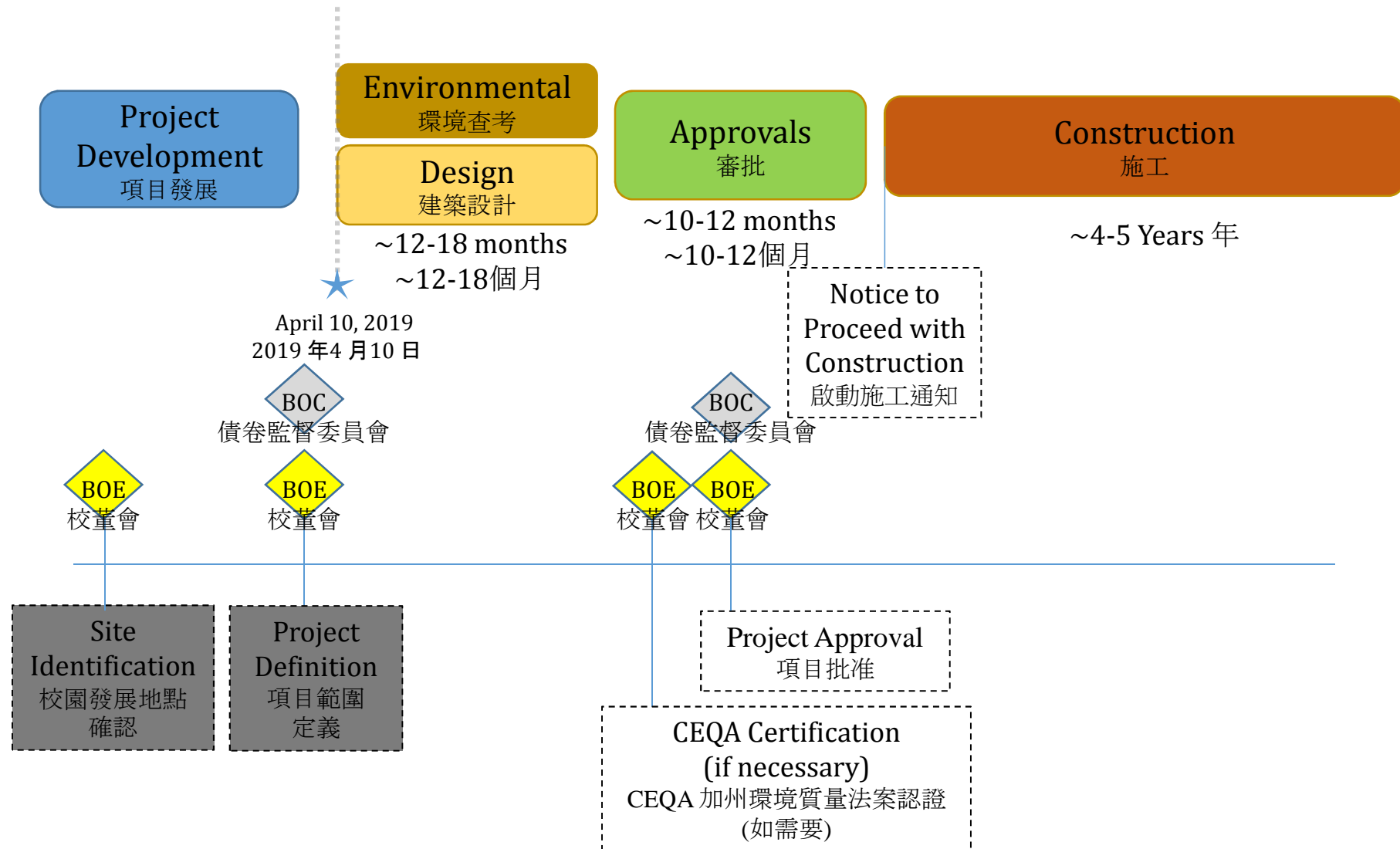

School Upgrade Program 校園提昇方案

Board Approved Goals

- Schools Should be Physically Safe and Secure
- School Building Systems Should be Sound and Efficient
- School Facilities Should Align with Instructional Requirements and Vision

Projects will modernize, build and repair school facilities to improve student health, safety, and educational quality

校董會所認可的目標

- 學校應有的環境安全及保衛防線
- 學校建築物系統應有的健全及效率
- 學校設施與教學目標和需求對應的一致性

該項目將會為學校設施進行現代化, 建設及維修, 以提昇學生健康, 安全及教學質素

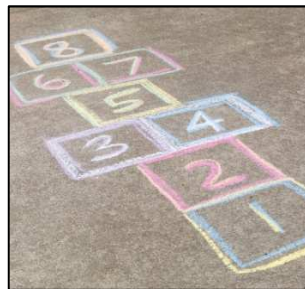

Why Lincoln HS? 為何是林肯高中？

School Sites are Prioritized Based on the Following Characteristics:

- Condition of Buildings and Outdoor Areas
- Buildings Requiring Evaluation for Earthquake Safety
- Proportion of Classrooms in Portable Buildings
- Adequacy of Controlled Public Access Points
- Adequacy of Size of Core Facilities
 - Food Services
 - Play Space
 - Auditorium/Performing Arts
- Density – Lots of Students on limited Site

全校區以下列特點而確定其校園的優先次序：

- 建築物及校園的現狀
- 需作防震安全評估的建築物
- 教室設於暫時性建築物的比例
- 保衛防線之充足度
- 核心設施大小之充足度
 - 飯堂
 - 校園室外空間
 - 禮堂、表演藝術的設施
- 密度 - 大量學生界限於較小的校園

Data and Information Gathering & Analysis

數據及資料收集與分析

Work Completed

- Conceptual Master Plans
- Facilities Condition Assessment
- Space Programming
- Educational Programming
- Topographic Surveys
- Seismic Evaluations
- Geotechnical Investigations
- Preliminary Environmental Studies
- Site Analysis

已完成的項目

- 總體概念規劃
- 設施現狀評估
- 空間規劃
- 教育規劃
- 地形調查圖
- 防震評估報告
- 地質土工調查報告
- 初步環境性的研究
- 校園環境分析

Work Underway

- Preliminary Design
- Community Outreach

進行中的項目

- 初步設計
- 社區通知推廣

Lincoln High School

Highlights

林肯高中

要點

- Opened in 1913
- Culturally significant site in the 1968 Walkouts and the school where Sal Castro was a teacher
- Grades 9-12
- Magnet Programs & Small Learning Communities
 - Environmental & Social Policy Magnet
 - Math, Science & Technology Magnet
 - SGS STEAM – Science for Global Solutions
 - VOICE: Victory Over Ignorance Through Culture and Education
- 開啟於1913年
- 具有重要文化意義的地點 - 源於1968年 Walkouts 以及Sal Castro擔任教師的學校
- 9 - 12年級
- 磁鐵計劃及小型學習社區:
 - 專著於環境與社會政策的磁鐵學校
 - 專著於數學、科學與科技的磁鐵學校
 - 專著於全球解決方案科學的磁鐵學校
 - VOICE:專著於透過文化及教育戰勝無知的磁鐵學校



Lincoln High School

Overview - School Facilities

林肯高中

概述 - 學校設施



- Originally Opened in 1913 and rebuilt in 1937 after the Long Beach Earthquake.
- Four historic buildings designed by architect A. C. Martin in the PWA Moderne style.
- Pedestrian bridge between east and west campuses
- Shares site with Pueblo de Los Angeles Continuation High School & Clinic
- 建校於1913年，而在長灘地震後於1937年重建。
- 四棟歷史建築是由建築師AC Martin 以 PWA Moderne 風格設計的。
- 東、西校園間的行人天橋
- 與 Pueblo de Los Angeles 持續高中及社區診所共享的校園場地

林肯高中

歷史區域 1

- Association with early-20th century school development in Los Angeles
- Period of significance 1913-41

- Association with Ethel Percy Andrus, California's first female high school principal
- Period of significance 1916-44

- 與洛杉磯二十世紀初的學校發展相關聯
- 重要時期在於 1913-41年

- 與加州第一位女高中校長Ethel Percy Andrus相關聯
- 重要時期在於 1916-44年

Source: Bing Maps © 2018

— District boundary
 ① Building
 ▲ Feature
 ■ Non-contributor

歷史區域
 建築物
 特徵
 無關聯者

北 N

- West Campus: Administration Building, Home Economics Building, Auditorium Building, Campus Quad, Administration Courtyard
- East Campus: Physical Education Building, Tennis Courts, Stairway, Walkway, Palm Trees

- 西校園：行政大樓、家政大樓、禮堂、主庭院、行政庭院
- 東校園：體育館、網球場、階梯、走道、棕櫚樹

Lincoln High School

Historic District 2

林肯高中

歷史區域 2

Criterion A/1/1 (association with important events or broad patterns of history)

- Association with 1968 Walkouts
- Period of significance: 1968

Criterion B/2/2 (association with important persons)

- Association with Sal Castro
- Period of significance: 1968

Contributors :

West Campus: Administration Building, Home Economics Building, Auditorium Building, Campus Quad

A/1/1 標準（與重要事件或廣泛歷史形態有關聯）

- 與1968年 Walkout 相關聯
- 重要時期在於1968年

B/2/2 標準（與重要人物有關聯）

- 與Sal Castro相關聯
- 重要時期在於1968年

相關建築:

- 西校園：行政大樓、家政大樓、禮堂、主庭院

Historic District #2 Map 歷史區域 2 圖



Lincoln High School

Historic District 3

林肯高中

歷史區域 3

Criterion C/3/3 (architectural merit or work of a master)

- Excellent example of PWA Moderne architecture, and as work of master architect Albert C. Martin
- Period of significance: 1936-41

Contributors:

- West Campus: Administration Building, Home Economics Building, Auditorium Building, Campus Quad, Administration Courtyard
- East Campus: Physical Education Building

C/3/3 標準（優質建築或大師之作）

- PWA Moderne 風格的優秀建築典範，亦是建築大師 Albert C. Martin 的作品
- 重要時期在於 1936-41 年

有關聯的建築：

- 西校園：行政大樓、家政大樓、禮堂、主庭院、行政庭院
- 東校園：體育館



- Project includes as part of Planning and Development
 - Due diligence
 - Site Assessment and CEQA
 - Public Process and Meetings

- 作為規劃和發展的一部分
此項目包括
 - 盡職調查
 - 項目地點環境分析與
CEQA 加州環境質量法案
 - 公共意見程序和會議

Lincoln High School

What We Learned

林肯高中

我們的瞭解

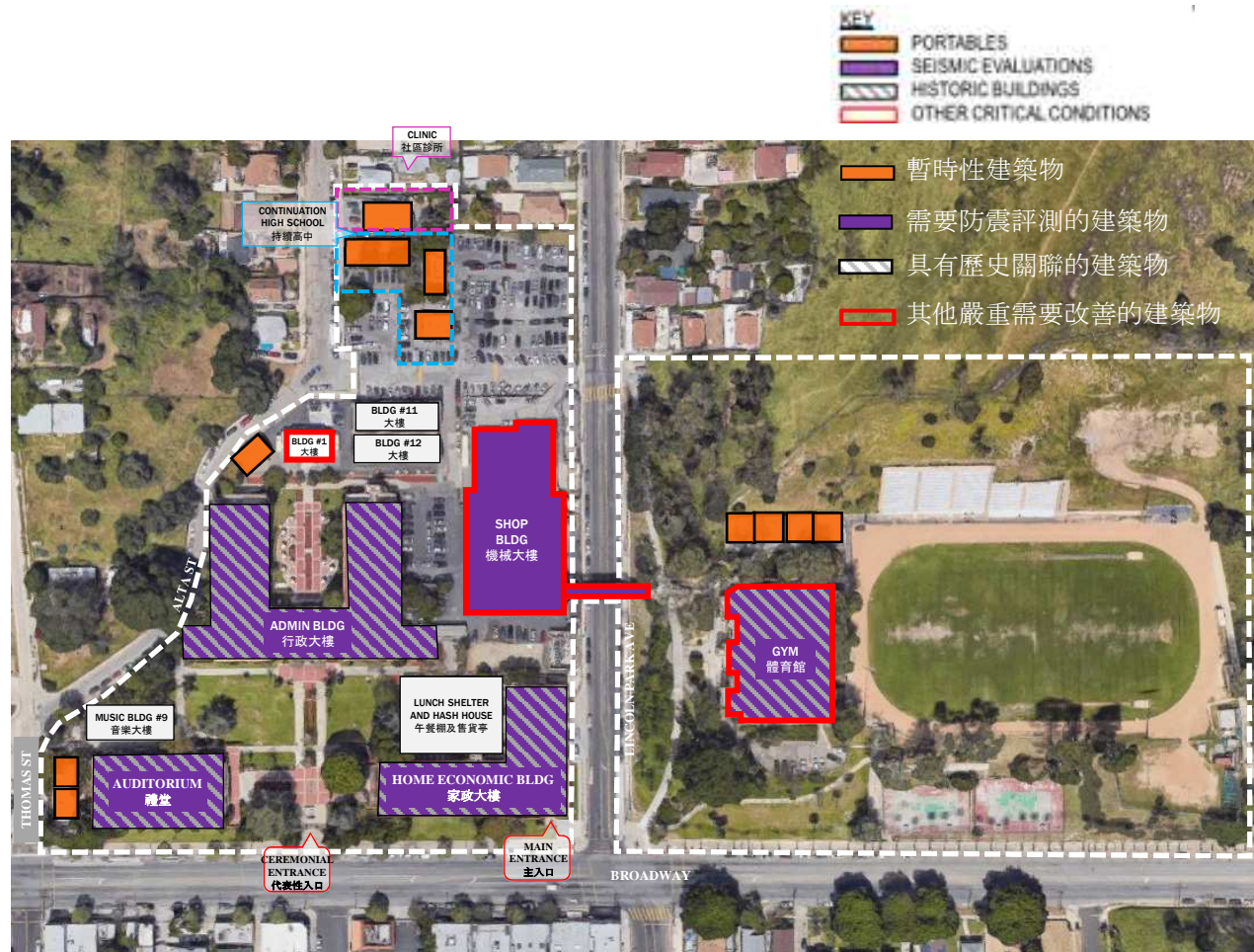

Major Findings

5 buildings and bridge require seismic upgrades

- Campus infrastructure in poor condition
- Accessibility constraints due to topography
- Existing easements restrict development zones
- Gym Building requires full electrical, plumbing, and HVAC upgrades

主要調查結果

- 五棟建築物以及行人天橋需作防震結構升級
- 無障礙道路可達度受地形所限
- 可開發地域受現有的土地安置權限制
- 體育館的電,水及空調系統需全面升級

Historically Significant Buildings:

Administration, Auditorium,
Home Economics, and Gym

重要歷史建築:

行政大樓、禮堂、家政大樓及體育館

Lincoln High School

Project Scope

林肯高中

項目範圍

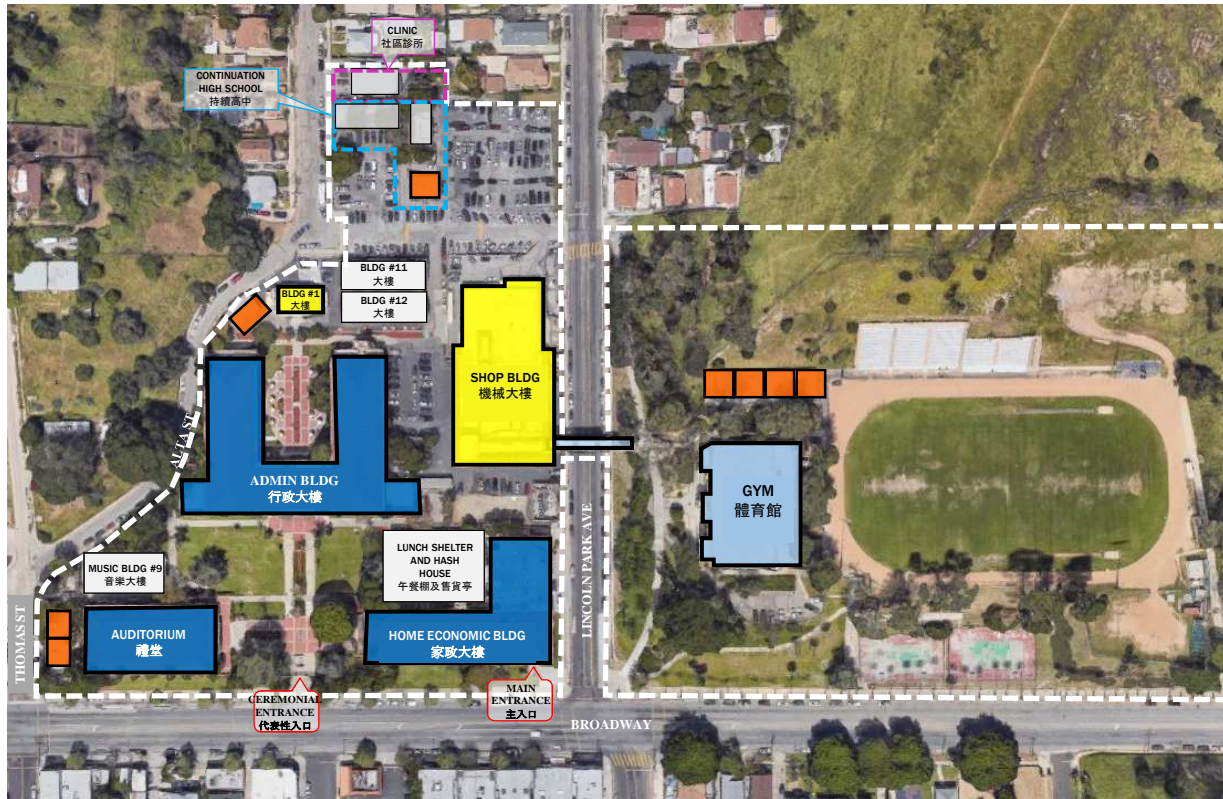

KEY 圖例

-  RELOCATABLES TO BE REMOVED
將被拆遷的暫時性建築物
-  BUILDINGS TO BE REMOVED
將被拆遷的建築物
-  BUILDINGS TO BE MODERNIZED
將被現代化的建築物
-  MINIMAL SEISMIC RETROFIT
輕微防震改造
-  MINIMAL MODERNIZATION
輕微現代化工程

Lincoln High School

Approved Project Scope

林肯高中

已批准之項目範圍

- New Construction approximately 38,000 SF
 - New Classroom Building and New Performing Arts Building
 - 2 General classrooms
 - 2 Science classrooms
 - Ceramics Suite
 - Studio Art Suite
 - Flexible Engineering/Maker space
 - Flexible Drama Classroom
 - Multi Media Computer Lab
 - Media/Filmmaking Classroom
 - Teacher Collaboration Room
 - Stair and Elevator Tower
 - Maintenance and Operations Building/Restrooms
- 新建築約佔38,000平方呎
 - 新課室及新表演藝術樓宇
 - 2個通用教室
 - 2個科學教室
 - 陶藝教室
 - 藝術教室
 - 彈性工程教室/製造間
 - 彈性戲劇教室
 - 多媒體電腦教室
 - 媒體/電影製作教室
 - 教師合作室
 - 樓梯及電梯塔樓
 - 運營與維護部/洗手間

Lincoln High School

Approved Project Scope (continued)

林肯高中

已批准之項目範圍 (續)

- Modernization and Seismic Retrofit approximately 216,000 SF
 - **Administration Building:** Seismic Retrofit and Full modernization (24 Classrooms)
 - **Home Economics Building:** Seismic Retrofit and Modernization (14 Classrooms)
 - **Auditorium:** Seismic Retrofit and Modernization
 - **Gymnasium:** Seismic Retrofit, Finish upgrades, system upgrades and programmatic Access upgrades
 - **Pedestrian Bridge:** Seismic Retrofit and Finish Upgrades
 - **All other existing Buildings:** Exterior and Interior finishes, programmatic access upgrades
- Site-Wide School Upgrades
 - Accessibility
 - Internet Protocol Convergence
 - Site Infrastructure
 - Security Infrastructure
 - Landscape and Hardscape Improvements
 - Parking
- 現代化及防震改造範圍佔地約 216,000 平方呎
 - 行政大樓：防震改造及全面現代化 (24間教室)
 - 家政大樓：防震改造及現代化 (14間教室)
 - 禮堂：防震改造與現代化
 - 體育館：防震改造、室內翻新、系統升級及無障礙可用度升級
 - 行人天橋：防震改造及鋪整路升級
 - 所有其他現有建築物：外內部表面翻新、無障礙可用度升級
- 校園升級
 - 無障礙可用度
 - 通用協合互聯網
 - 校園基礎設施
 - 保安防衛線設施
 - 園林與道路改進
 - 泊車處

Lincoln High School

Conceptual Site Plan

林肯高中

校園規劃概念

- ① AUDITORIUM BUILDING
禮堂
- ② MUSIC BUILDING
音樂大樓
- ③ ADMINISTRATIVE (100) BUILDING
行政(100)大樓
- ④ HOME ECONOMICS (500) BUILDING
家政(500)大樓
- ⑤ CENTRAL PLANT
校園中央冷暖機械塔
- ⑥ CLASSROOM (700) BUILDING
課室(700)大樓

- ⑦ CLASSROOM (700) BUILDING
課室(700)大樓
- ⑧ CONTINUATION HS
持續高中
- ⑨ CONTINUATION HS
持續高中
- ⑩ ST JOHN'S CLINIC
ST JOHN'S 社區診所
- ⑪ PHYSICAL EDUCATION BUILDING
體育館

- ▲ CEREMONIAL PED ENTRY
代表性入口
- ★ MAIN PED ENTRY
主入口
- ▲ SERVICE & AUTO ENTRY
營運及汽車入口
- EXISTING TREE
現有樹木
- PROTECTED TREE
現有受保護樹木
- FENCE
圍欄

- NEW GREEN SPACE
新綠化空間
- NEW HARDSCAPE / RAMP
新步行路/ 傾斜路
- STUDENT PICK UP / DROP OFF
學生上、落車地點
- ADA PARKING ADA
泊車
- NEW BUILDING
新建築
- EXISTING BUILDING
現有建築

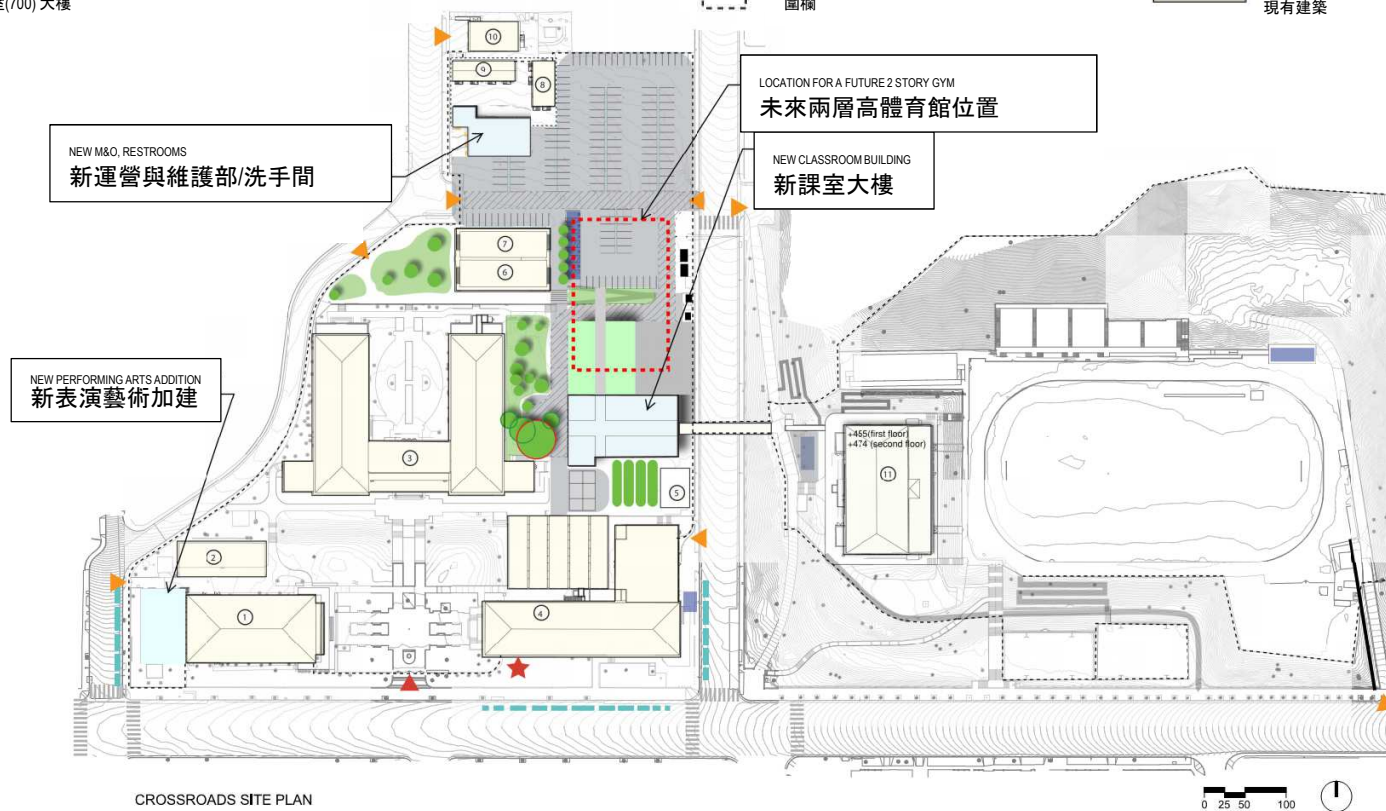

Lincoln High School

Plans for Future Athletic Facilities

林肯高中

未來運動設施計劃

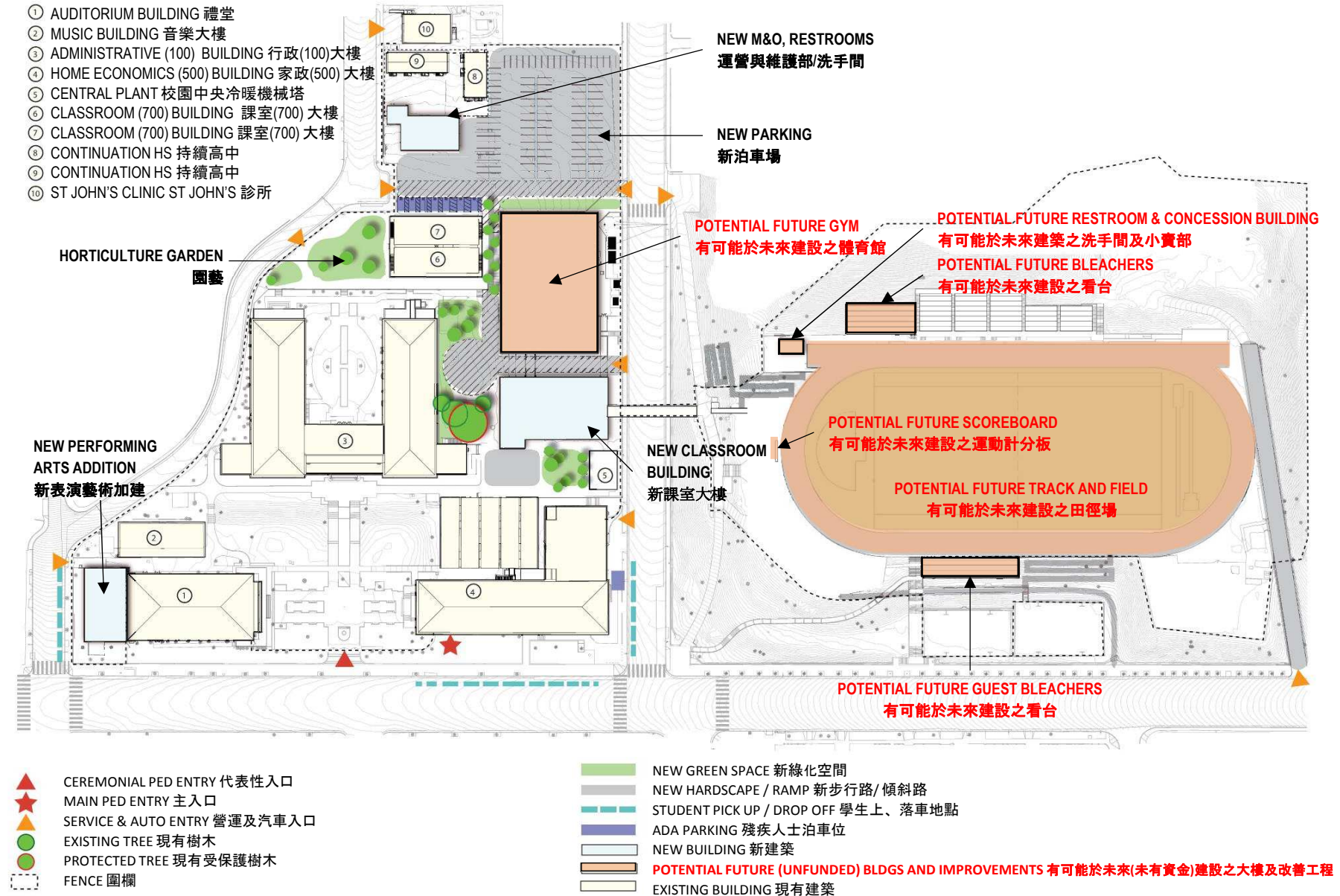

Community Engagement Process throughout the Life of a Project

整個項目持續週期中的社區參與過程

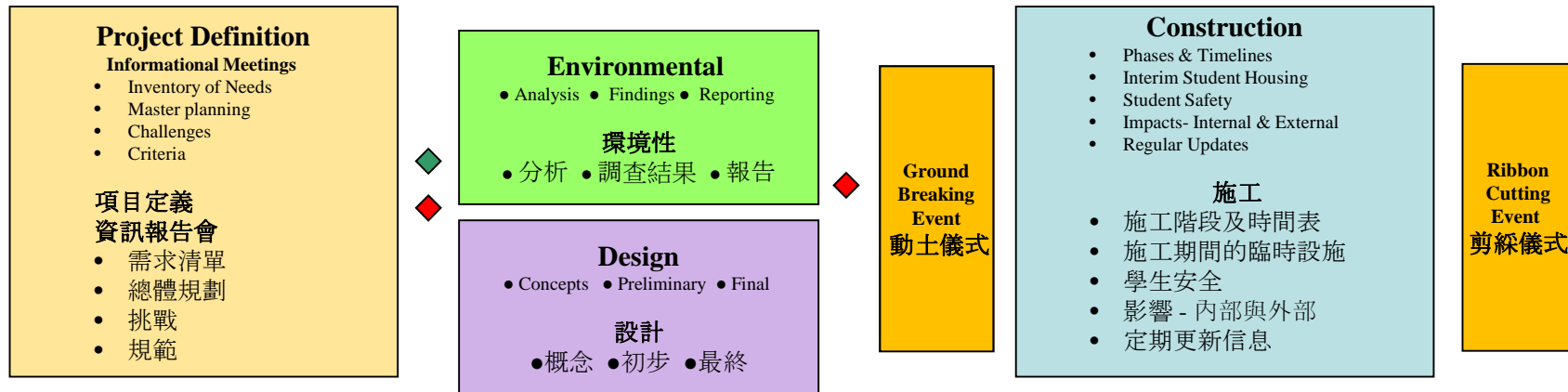

Questions and Comments 建議與問題

For More Information Please Contact:

如需要更多的資訊, 請聯絡:

LAUSD FSD Community Relations

學區設施服務部 社區關係組

Fortunato Tapia, FSD Community Relations

設施服務部社區關係員:

fortunato.tapia@lausd.net

- Main Line 主線 (213) 241-1340
- Direct Line 直線 (213) 241-1338